

GTX COOKBOOK

v 3.0



GTX

USER REFERENCE GUIDE
BROTHER.CO.NZ



Mandatory Temperature & Humidity Requirements:

Help keep your printer in warranty while saving on ink, consumables, and time

TEMPERATURE

HUMIDITY

The printer can operate outside of these ranges however it may use more ink or take longer to print.

	MIN	18°
	MAX	30°

	MIN	35
	MAX	85

If the Temperature and Humidity is not enough, then add an Evaporative Humidifier

To check Go to the menu: **Maintenance** > **Temperature/Humidity info** >

If the temperature is too cold, the printer will automatically switch to Low-Temp Mode and reduce the speed!
Damages resulting from being too far outside of the environmental requirements may not be covered by warranty



PRE-TREATMENT RATIO

[Watch the Video: Learning to Profile a Garment for Pre-treating](#)

You can use an empty distilled water jug and marker to measure out the amount of Pre-Treatment by drawing a line on the jug - then fill to that line twice with distilled water, adding the contents into the Ready to Use container.

1 Litre	2 Litres	3 Litres
Pre-Treatment Solution	Distilled Water	Pre-Treatment Ready to Use
1.25 Kg	2 Kg	3.25 Kg

+ **=**

This mixing ratio might vary due to the type of garment which is used.



PRE-TREATMENT QUANTITY on T-SHIRTS

[Watch the Video for Understanding the Highlight-Mask Check Pattern](#)

Pre-Treatment Ready to Use Quantity	High Absorbency <small>Thick materials or open weaves like hoodies</small>	=	40-50 Grams
	Med. Absorbency <small>Regular Cotton Tees 113-170gs</small>	=	30-39 Grams
	Low Absorbency <small>Thin Material + Blend or Specialty Items</small>	=	15-29 Grams



The correct Pre-treat volume for a garment should be determined by a **garment's absorbency rate** in conjunction with using the highlight check pattern to help determine driver ink settings.

Don't forget that you have to define a surface of 35 x 40 cm (14 x 16 inches) with your Pre-Treatment machine and weigh with a scale after applying the Pre-Treatment liquid on a T-shirt.

HEAT PRESS SETTINGS for Pre-Treatment DRYING



Pre Treatment
1/2 distilled water

35
Seconds

180°C

75 - 80
PSI

✂ Use a **Silicon sheet** on the heat press to cover the pre-treatment and **clean** the surface every 5 T-shirts



You can also use Parchment paper when curing the Pre-treatment in order to minimise the need to clean off the covers and to avoid issues with fibers standing up on the garment

HEATPRESS & TUNNEL DRYER SETTINGS for INK CURING



HEATPRESS
Ink Curing

35
Seconds

180°C

10 - 20
PSI

TUNNEL DRYER
Ink Curing

3:30
Minutes

160°C

✂ Check the **Real Temperature** with a **Probe** or with **Strips** to be sure that you are safe for washability

Watch the Video: [Using and Storing the CR Holding Pin](#)

VERY IMPORTANT



The Brother **GTX** should **ALWAYS** be left with the Power **ON**



NEVER shut **OFF** the printer unless instructed to by the display panel. Power is required to perform the white Ink recirculation from time to time.

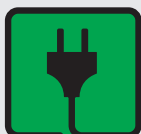

NEVER POWER OFF THE PRINTER!

In the event that the power goes out or your printer has an error during printing, push the **Carriage** back all the way to the left to dock it and use the **Fixing Pin** to lock it in place.

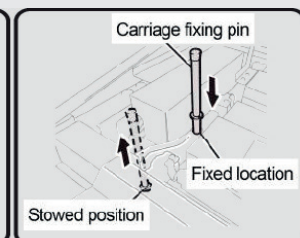
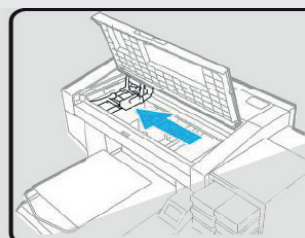



DAILY AGITATION OF WHITE INK

Watch the Video: Daily Process of GTX White Ink Agitation

Perform the procedure shown below if the message "Remove the white ink cartridge and shake it" is displayed before starting operation.

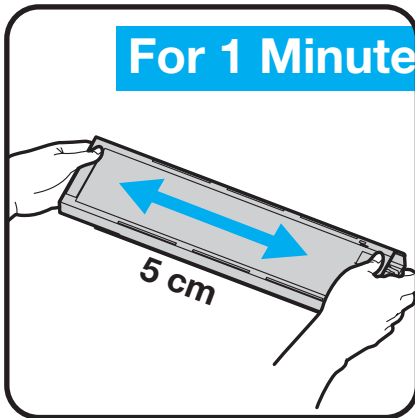

Remove the white ink cartridge from the printer. Shake the cartridge **horizontally 100 times** side to side to stir the white ink.

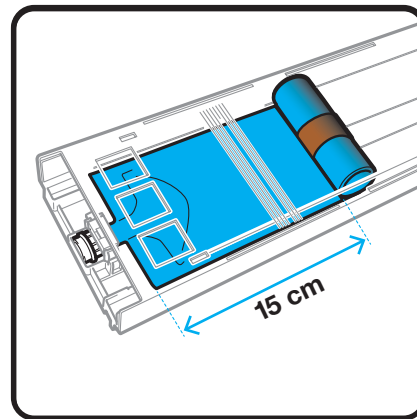



When the ink pouch becomes approximately 15cm in length, shake the cartridge with its cover open. This will slightly unwind the ink pouch and make the ink easier to stir.

Repeat the same process on the other white ink cartridge.



When to Agitate the White Ink and Press "OK"



It's extremely important to understand how to agitate the ink daily - it's just as important to understand when to perform both the agitation and press  on the panel after reinserting the ink. If you are not printing for a few days, you should avoid doing this process. There are some rules to follow as to when you should agitate the ink and press . The printer will automatically perform a White Ink Refilling to refresh the ink in the lines and head after you reinsert the ink cartridge and press .

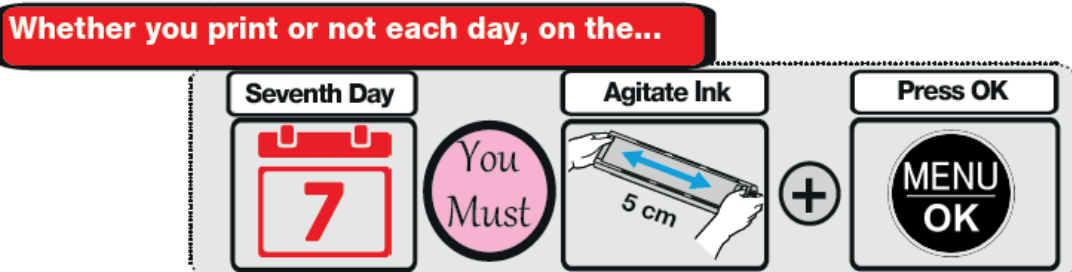
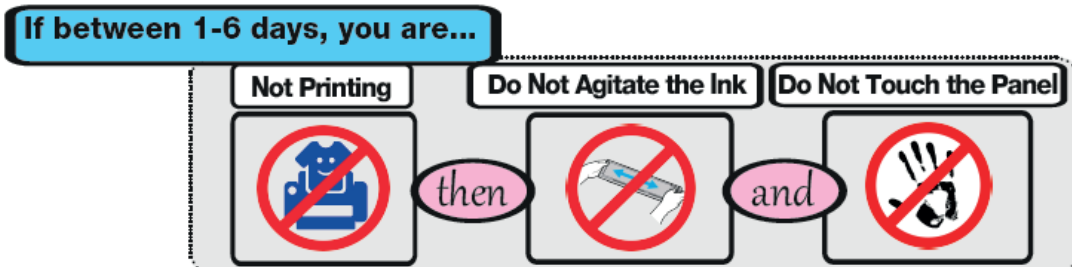
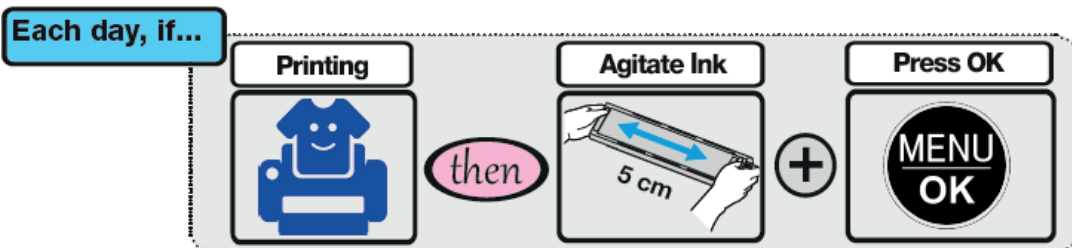

POUCH REPLACEMENT - VERY IMPORTANT

If you know you're going to print a large order or are low on ink, ensure you have spare ink on hand. Running the printer dry can damage the unit and keep you from finishing a job which can lead to costly repairs!

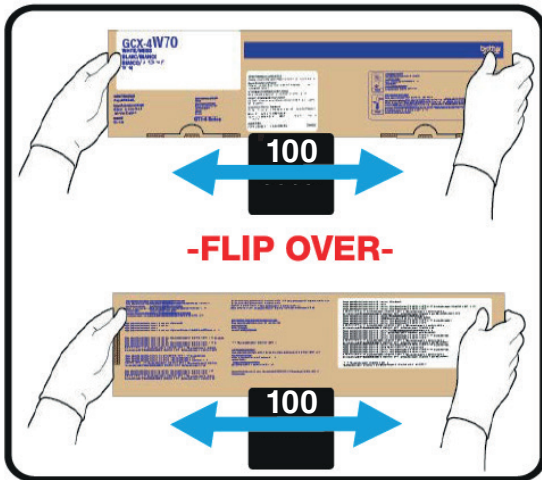

Agitate the new white ink side to side while still in the carton before loading it into the cartridge. New ink should be agitated 100 times on each side. Following this process will save time as both ink pouches are agitated at the same time in the carton.

POUCH REPLACEMENT - VERY IMPORTANT

Open the cartridge's lid on a **flat surface** and remove the empty pouch. Carefully unpack a new ink pouch from its shipping carton. **Avoid wrinkling the pouch.**

Push the green tip end of the ink pouch into the cartridge until it **clicks** into place. Straighten the ink pouch to align it with the gutters of the of the cartridge lid, and mount in position inside the metal spring by pulling it with your hand.

(If the edge of the ink pouch is bent or undulating significantly, flatten and straighten it with your hand)

Align the pouch so that it sits in the middle of the cartridge. Close the lid and verify that the spring is rolling to the front. Raise the cartridge to a 45° angle and push on the two upper metallic latches to add more tension to the ink pouch.



Attach a shelf life **sticker**

09. 2019
XXXX

 included with the ink pouch onto the front of the cartridge.

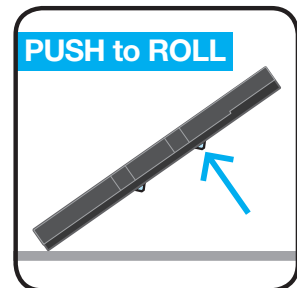
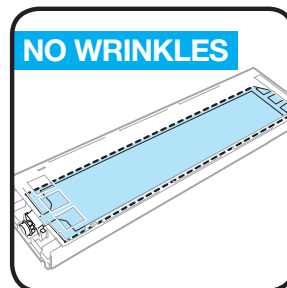
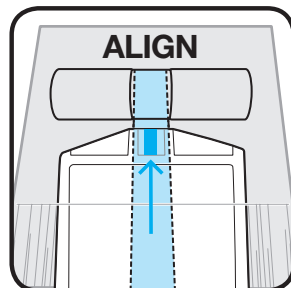
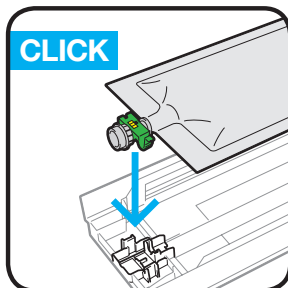

STORED INK

If you are storing white ink for more than one week without use, then you need to flip over the ink carton weekly to prevent the ink pigments from settling in the pouch.

BEST PRACTICE FOR PRINTING >>> A MUST!

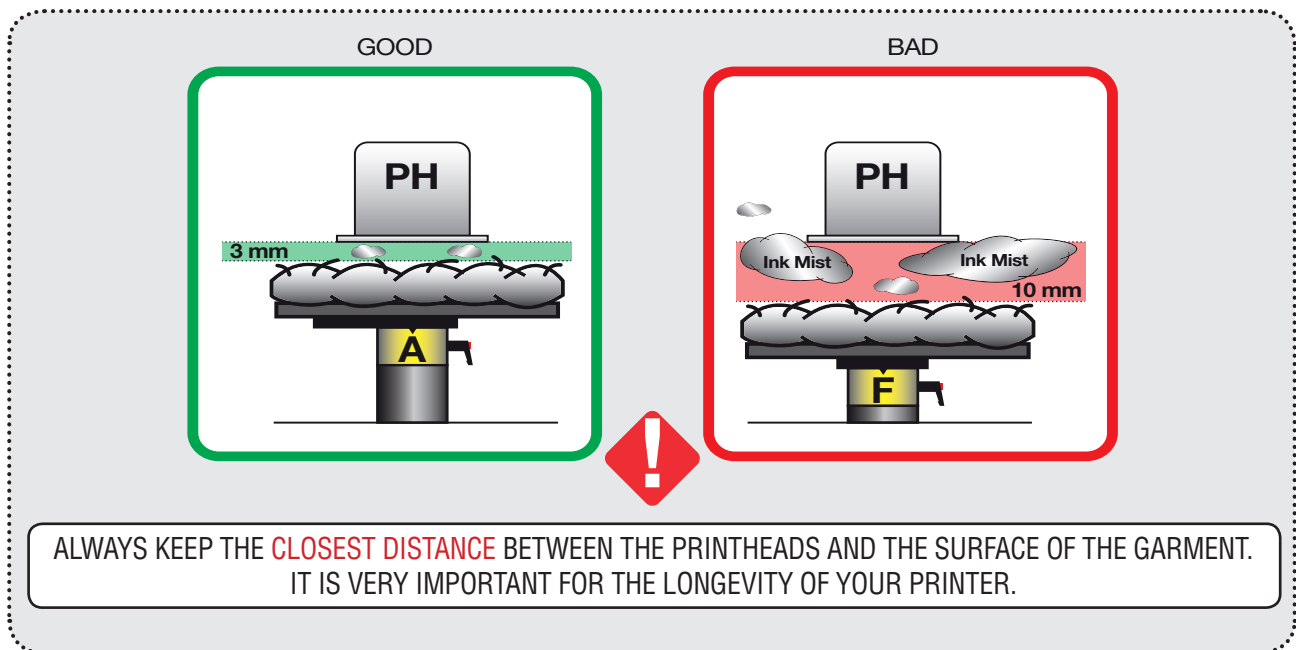

[Link to the Document: Use of the Platen and Platen Mechanism](#)

ADJUSTING THE HEIGHT OF THE PLATEN

To achieve optimum printing quality when a thicker textile is used, adjust the platen height relative to the thickness of the textile.

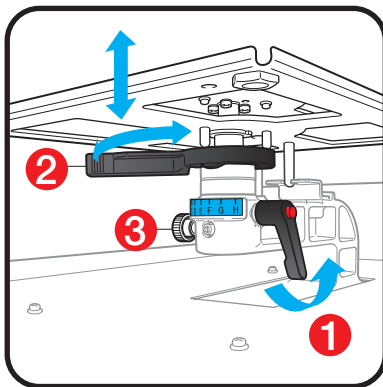

To adjust the platen height, loosen the **Platen Fixing Lever ①** and move the **Platen Height Adjustment Lever ②** to a lower position. Re-tighten the Platen Fixing Lever if you are happy with new distance. Flatten down all the wrinkles of the fabric.

To check if the new textile is not detected by the **sensor**, push the button  and **repeat** the process **if needed**. If you need to decrease the gap further, remove 1 or 2 collars, loosen the knob **③** and push down the platen bearing by 1 or 2 steps.

Re-attach everything and tighten the **Platen Fixing Lever**

Don't forget to **return** the platen to the **A** position after printing on thicker material. Always leave the knob **③** tight after changing position.

*if you need to print above the hem and seams, choose **UNI-directional** printing to keep quality.*



 There are several maintenance procedures that **must be performed** daily, weekly, or prompted basis in order to keep your printer performing **properly**. This short guide describes the maintenance procedures that must be performed.

Please see the Instruction Manual for each specific maintenance procedure for step by step instructions.



Please also check useful videos at <https://www.youtube.com/user/BrotherGTSeries/videos>



DAILY MAINTENANCE

[Link to the Document: Printing Nozzle Checks](#)

NOZZLE TEST

 **TO BE DONE EVERY WORKING DAY**

You have to print a nozzle test for White & CMYK **every morning** before using the printer. It is the only way to know the status of the nozzles in the machine.

HOW TO DO A NOZZLE TEST ?

Always place the **Platen** at level **A**

Menu > **Test Print** > **Nozzle Check CMYK** >  *to check colors on a white paper sheet*

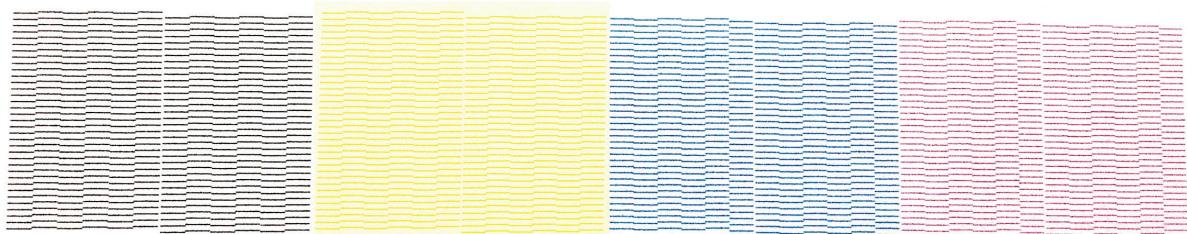

Repeat the same procedure to perform a nozzle test of the **White** printhead

Menu > **Test Print** > **Nozzle Check White** >  *to check White on a black paper sheet or inkjet plastic sheet*

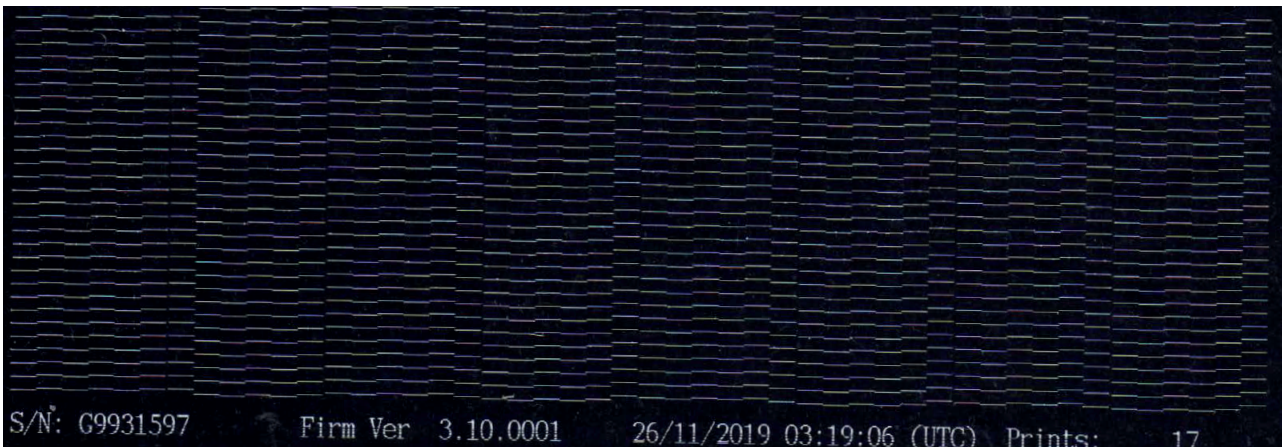

If you have nozzles missing or nozzle deflections, then refer to the Head Cleaning Instructions on the next page

Missing Nozzles & Deflection Cleanings & Flash Firing

The Missing horizontal pins on the test print pattern represents the print head nozzles that are blocked with debris and therefore not showing up. Depending on how many nozzles/pins are missing, will require you to perform one of the print head cleaning functions as shown below. **NOTE: This cleaning process can be used for CMYK or White**

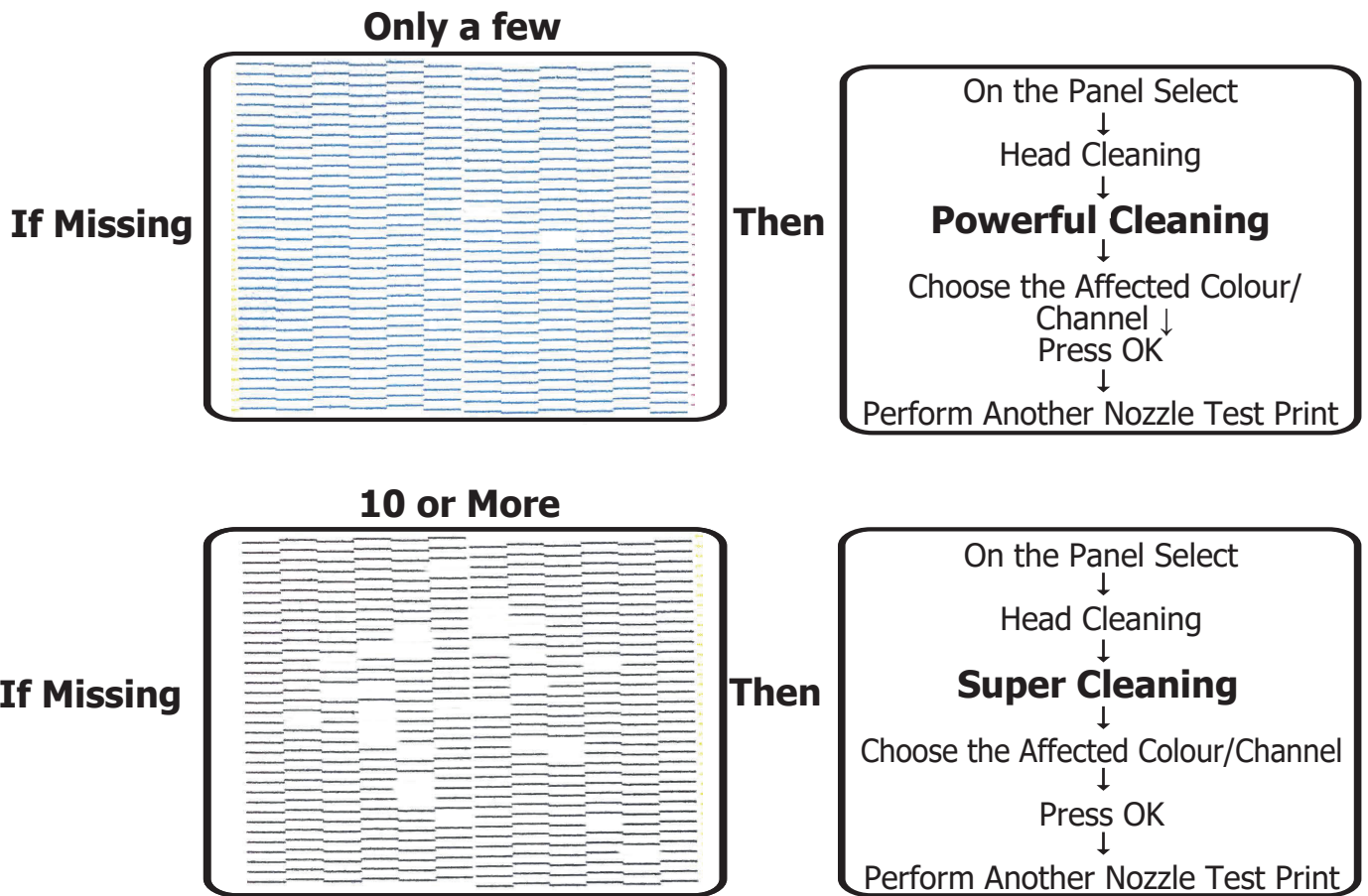

Repeat the same process as needed up to 3 times and ensure all maintenance has been performed such as cleaning the cap and wiper blade. Also check that the wiper cassette is fresh and still has moisture. If there is no improvement by the 3rd time, please contact your dealer or service centre.

Deflection & Flash Firing

If

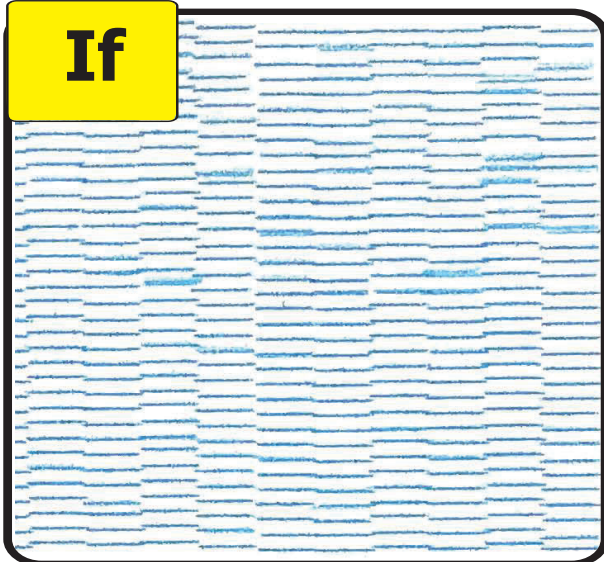

Deflection appears as odd bunched up or gapped lines - sometimes the horizontal bars will appear blurred and staggered.

When this is present you will want to perform a **Flash Fire Cleaning**.

then

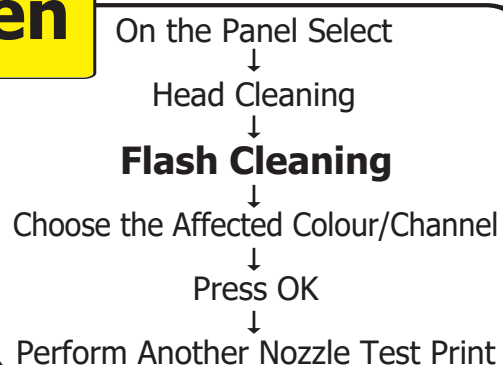

If this does not resolve the matter please contact your dealer or Brother representative for further troubleshooting.

WEEKLY MAINTENANCE PROCEDURES

 To achieve a good **weekly maintenance** you will have to do the following actions:





WEEKLY MAINTENANCE

+ Suction Cap Cleaning

+ Exhaust Cleaning

+ Wiper Cleaning

+ Nozzle Guards Cleaning

Always use this menu to perform cleanings or replace parts: 
Menu > Maintenance > Maintenance Part Clean/Replace  and follow instructions on the display

Suction Cap & Exhaust Cleaning

 **TO BE DONE EVERY WEEK**

The black silicon lips of the two suction caps should be cleaned using the **Cleaning Stick T** dipped in **Cleaning Solution**. Carefully remove any build-up of dried ink sitting on the lips of the suction caps. This will prevent air leaks and keep the good suction of the pumps.

Be careful not to touch the foam - keep it flat.

The **four extrusion lances** (see in the blue circle...) and the **hole** sitting on the side of the capping at the **Exhaust** position also need to be cleaned and free of dried ink.

Always clean the Exhaust hole first, then proceed backward to clean the lances.

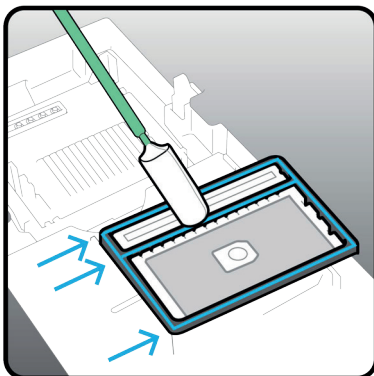
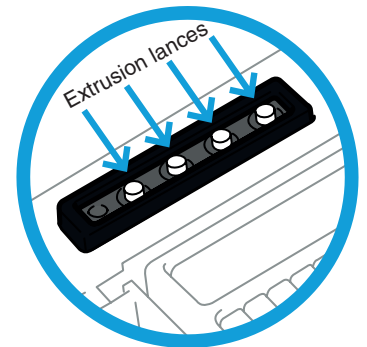

Suction Cap Cleaning

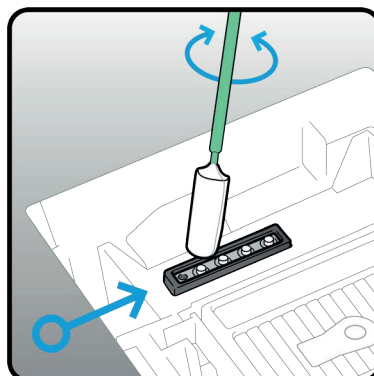

Exhaust Cleaning

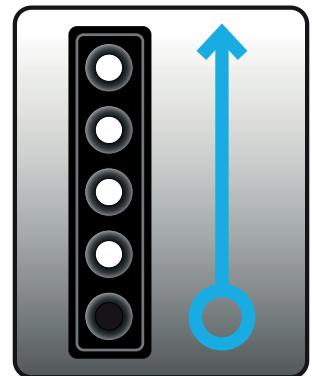

Direction to clean

Wiper Cleaning

! TO BE DONE **EVERY WEEK**

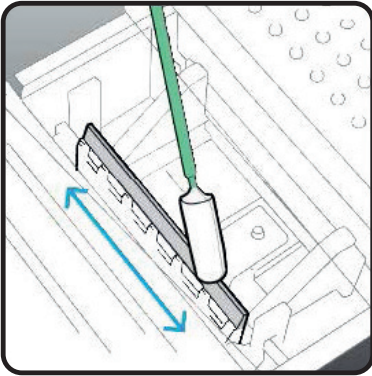

Both white plastic wipers [White & CMYK] should be cleaned on **both sides** and the **top** with the **Cleaning Stick T** dipped in **Cleaning Solution**.

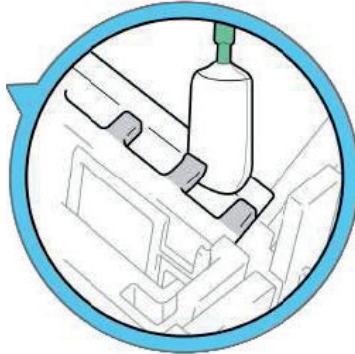

Use the tip of the **Cleaning Stick T** to clean under the teeth of the wiper holder and remove the dried ink.

Important: Use separate cleaning sticks for each colour.

Nozzle Guards Cleaning

! TO BE DONE **EVERY WEEK**

Wipe clean the two nozzle guards **1** & **2** with the **Clean Stick R** dipped in **Cleaning Solution**.

Be sure not to touch the nozzle surface **3 at all.**

Manually move the carriage to such a position that you can perform the cleaning with ease.



Use a mirror for a better view

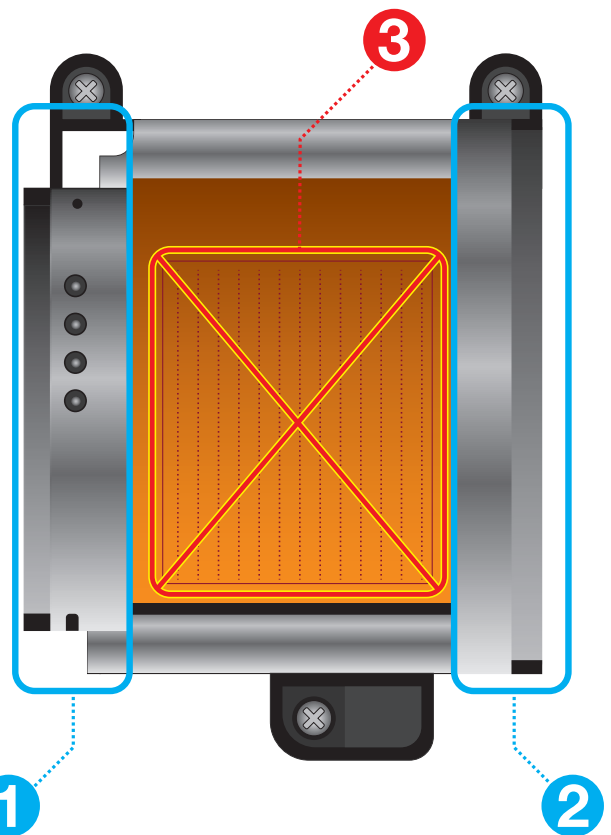
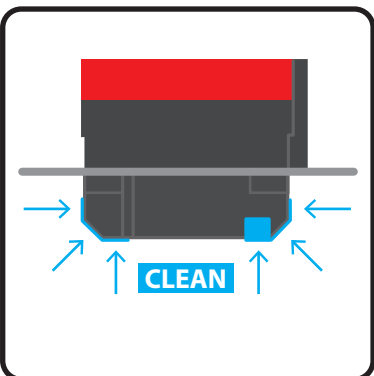
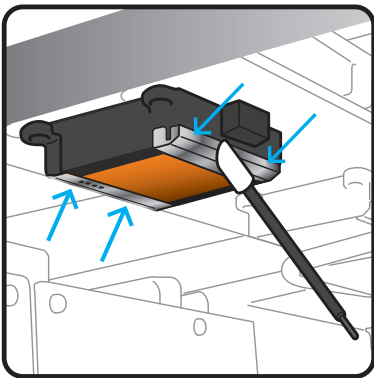

Discard any remaining Cleaning Solution from the Cleaning Cup in the **Waste Tank** **Only** located below the printer.

DO NOT POUR INTO THE PRINTER MECHANISM



MAINTENANCE PARTS CLEANING & REPLACING PROCEDURES

WARNING **ERROR**

In case of Warning/Error messages please follow the following procedures:

Always use this menu to perform cleanings or replace parts:

Menu > Maintenance > Maintenance Part Clean/Replace > and follow instructions on the display



WIPER CLEANER REPLACEMENT Watch the Video: Replace the GTX Wiper Cleaner

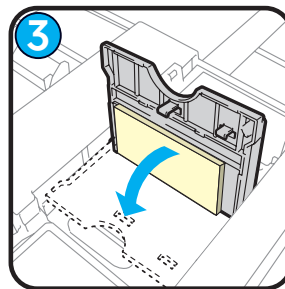
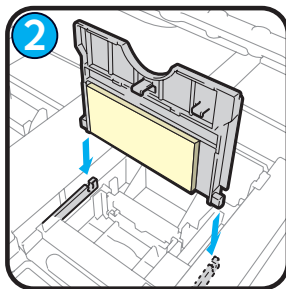
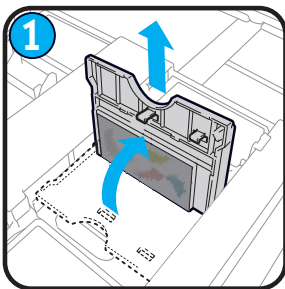

Simply remove the old **Wiper Cleaner** by lifting it up. Replace with a new one.

FLUSHING FOAM REPLACEMENT Watch the Video: Flushing Foams Replacement

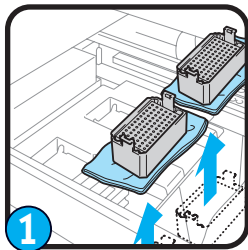

Lift up the **flushing receivers** and place them on a waste cloth to avoid dripping ink.

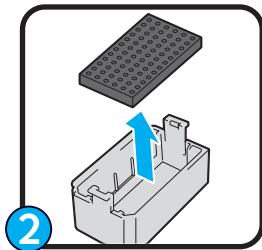

Remove **Flushing Foams** and clean the holes of the 2 receivers.

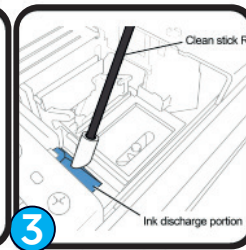
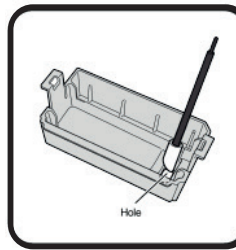

Check and clean where the retainer sits on the maintenance unit to ensure ink is not blocking drainage.

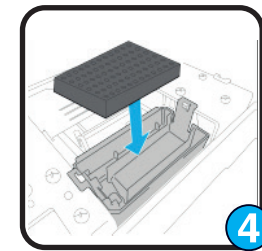

Install new foams and return the receivers to their original location.

FAN FILTER REPLACEMENT

Watch a Video: Fan Filter Replacement

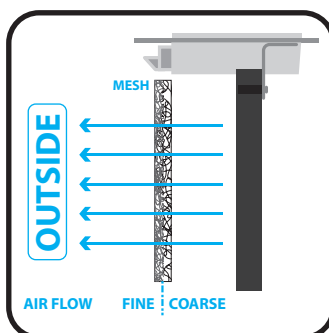
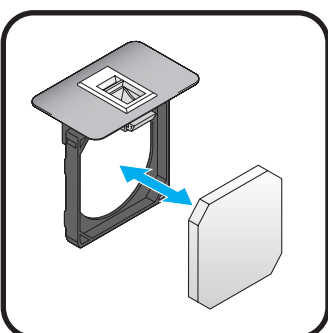

Remove the 2 Fan Filter holders from the top rear of the printer.

Remove the old filters and install **new Fan Filters** in two black Fan Filter holders.

Note: Face the coarse mesh side of the Fan filter towards the inside of the printer and the fine mesh side towards the outside of the printer.



ADDITIONAL WEEKLY MAINTENANCE



Visual inspection is important to keep your printer up and running. Verify all the moving parts of the machine and also check for leakage of ink.



Please follow all the instructions that appear on the **printer display**.

When you see a yellow number, push the **key** to review the warning messages. Complete all tasks as instructed as priority before continuing to print.



INTERNAL CLEANING OF PRINTER

Regular cleaning of your printer will ensure smooth operation of your equipment

Clean the inside of your printer if it is covered with Ink



Always use this menu to perform cleanings or replace parts:

Menu > Maintenance > Maintenance Part Clean/Replace > and follow instructions on the display

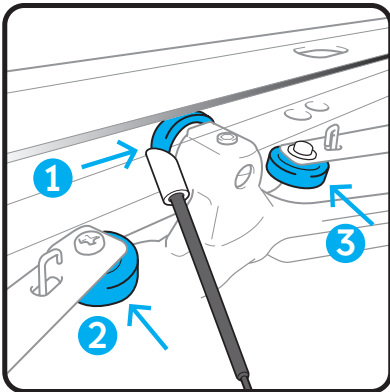

Use the **Clean Stick R** dipped in **Cleaning Solution** to wipe away the stains on the **3 Carriage Roller Guides**. Move the carriage from side to side to wipe all around the 3 rollers completely.

Clean the **Carriage Guide Shaft** and the **3 sides** [upper, front, and lower] of the **Roller Guide** with a non pilling cloth and moisten with a small amount of **isopropyl alcohol [95%]**

Do not use alcohol on any other parts except for the carriage guide shaft and the roller guide.

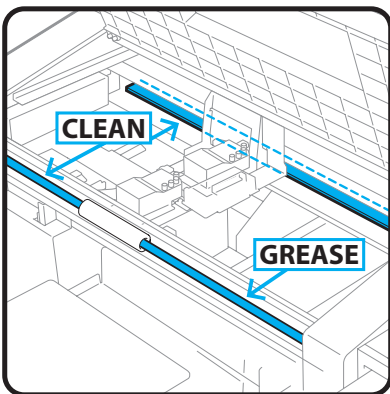

Apply a small amount of **Molykote 30 Grease** onto the **Carriage Guide Shaft** **only**. [never on the Roller Guide]

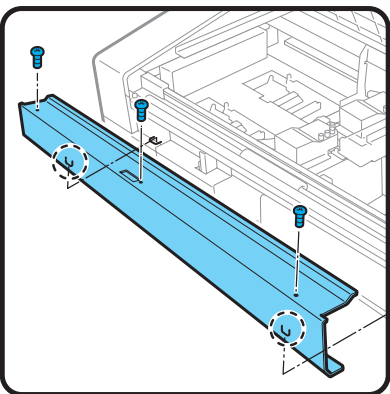

Remove 3 screws to take out the encoder metal cover. With your non-pilling cloth that is moistened with **alcohol**, carefully clean both sides of the **Encoder Strip**.

Perform a **CR Speed Adjustment**.

Menu > Printer Setting > CR Speed Adjustment > OK

Print out a **Nozzle Check** pattern.

WHEN YOU'RE NOT USING THE PRINTER FOR A LONG PERIOD OF TIME





Depending on the length of time you intend on not using the printer will determine which run down procedure to follow:

NEVER turn the printer **OFF**, otherwise, the printer may be damaged.



UP TO 2 WEEKS

- Clean the Nozzle Guard, Wiper Blade and Exhaust Cap
- Empty the **waste ink** in the **Waste Ink tank**
- Check the amount of **Cleaning Solution** in the Cleaning Solution **tank** is filled to the maximum level
- Agitate the white ink if a white ink cartridge stirring message is displayed on the operation panel screen
- Print out a **Nozzle Check** pattern

FOR MORE THAN 2 WEEKS (Use White ink Pause mode)

- Clean the **Nozzle Guard**, **Wiper Blade** and **Exhaust Cap**
- Empty the waste ink in the waste ink tank
- Check that the amount of Cleaning Solution in the Cleaning Solution tank is filled to the maximum level
- From the menu, select [Maintenance] > [White Ink Pause Mode] > [Enable] Then Press 
- Remove the White ink cartridges and replace both White Ink Pouches with Maintenance Pouches [GCX-4S70]. Insert the White Ink Cartridges back into the printer. Then Press 

Note: When you need to print with white ink again, you will need to **Disable** White Ink Pause Mode

- Empty the waste ink in the waste ink tank
- From the menu, select [Maintenance] > [White Ink Pause Mode] > [Disable]. Then Press 
- Remove the White ink cartridges and replace both Maintenance Pouches with brand new White Ink Pouches. Insert the White Ink Cartridges back into the printer. Then Press 

INK & SOLUTIONS STORAGE

CMYK & White inks, Cleaning Solution, Maintenance Solution & Pre-Treatment Solution should be stored at a temperature range between 0° and 40°.

Do not store consumables outside this temperature range

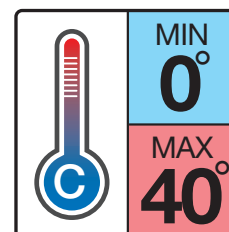

HOW TO EXTRACT A LOG FILE FROM THE PRINTER

Switch on the printer and insert a **USB stick**

Go to the menu: **Maintenance** > **Log copy to USB** > 

GTX INK & CONSUMABLES

	Description of product	Product Code	Price/Unit*
INK POUCHES	C Cyan Ink Pouch 500cc [GCX-4C50]	BGCX40C05000112	
	M Magenta Ink Pouch 500cc [GCX-4M50]	BGCX40M05000112	
	Y Yellow Ink Pouch 500cc [GCX-4Y50]	BGCX40Y05000112	
	K Black Ink Pouch 500cc [GCX-4K50]	BGCX40K05000112	
	W White Ink Pouch 2 x 500cc [GCX-4W50]	BGCX40W05000022	
	C Cyan Ink Pouch 700cc [GCX-4C70]	BGCX40C05000112	
	M Magenta Ink Pouch 700cc [GCX-4M70]	BGCX40M07000112	
	Y Yellow Ink Pouch 700cc [GCX-4Y70]	BGCX40Y07000112	
	K Black Ink Pouch 700cc [GCX-4K70]	BGCX40K07000112	
	W White Ink Pouch 2 x 700cc [GCX-4W70]	BGCX40W07000022	
LIQUIDS	CS Cleaning Solution 1.9Kg [GCX-4E02]	BGCX40E002K0052	
	MS Maintenance Solution Pouch 700cc [GCX-4S70]	BGCX40S07000012	
	PT Pre-Treatment Liquid 5Kg-4L [GCX-4P05]	BGCX40P005K0042	
	PT Pre-Treatment Liquid 20Kg [GCX-4P20]	BGCX40P020K0032	
PARTS	W Capping Pouch [2 pieces in the box]	SB6673001	
	Flushing Foam [2 pieces in the box]	SB7006001	
	Fan Filter [2 pieces in the box]	SB7007001	
	Cleaning Sticks Type R [50 pieces]	SB7008001	
	Cleaning Sticks Type T [50 pieces]	SC0032001	
	GREASE EM-30L [1 piece]	SB3229101	
	Platen Sheet Adult [1 piece]	SB6667101	



NOTES



CONTACT DETAILS OF YOUR BROTHER DEALER

A large, empty white rounded rectangular box intended for entering contact details.